



Naturally, the  
**Most Effective**  
 Antioxidant Alkaline Water

**User's Manual**



**AOX 6600H**

**Hot/Cold  
 Antioxidant  
 Alkaline Water  
 Dispenser**



**SINGAPORE  
 GOOD  
 DESIGN**

**Multi-Award Winning Brand**



**AOX Pte Ltd**  
 28 Sin Ming Lane  
 #03-143 Midview City  
 Singapore 573972

[www.AOX.com.sg](http://www.AOX.com.sg)  
[sales@aox.com.sg](mailto:sales@aox.com.sg)

**6456 4321**

# *Thank you for choosing* **AOX!**

*We are confident that you will benefit much from your Hot/Cold AOX-6600H health transforming drinking water. These units are equipped with 4-stage filters for removing impurities, bacteria and viruses from your water. In addition, it comes with a super Heavy Duty Storage Tank Technology.*

## **F12-U: 1 Micron Sediment Carbon Block Filter**

Filters sediments such as rust, particles, sand and lead in the water. It removes organic chemical substances such as chlorine, detergent, THM, pigment and carcinogens. Hence, it alone acts like a 2-Stage Sediment/Carbon filter. Foul smell is also eliminated, leaving fresh tasting water for your consumption.

## **F3-U: AOX Antioxidant Alkaline Minerals Filter**

Makes the water alkaline and antioxidant in nature. It supplies essential minerals such as calcium, potassium, magnesium, sodium and silica to promote healthy cells, bones, joints, organs and skin. Furthermore, it decreases the size of water molecule clusters.

## **DDMI : Dual Dynamic Microbial Intervention**

Made with Dual Dynamic nanofibers which consist of very small pore structure on a thin sheet to ensure the removal of heavy metals such as colloidal and soluble lead. Dangers of heavy metal consumption and accumulation of heavy metals are nausea, vomiting, diarrhoea, abdominal pain, heart problems etc. In addition, the fibres are treated with microbial filtration, removing up to 99.99% of bacteria and viruses.

## HOW TO CHANGE THE FILTERS?

1. Close the water valve (**Photo A**)
2. Turn off hot water switch (**Photo B**)
3. Lift up both lever and drain off excess water (**Photo E**)
4. Turn anti-clockwise to remove the cover and drain off any excess water (**Photo F**)
5. Pull up the tube (**Photo G**) and remove the whole set of filters (**Photo H**)
6. Insert the new filters in the same sequence (**Photo H**)
7. Close the top cover and tighten the 2 nuts (**Photo C**)
8. Turn on the water valve (**Photo I**)
9. Wait for 15 minutes for the water to fill up both Hot/Cold tanks inside the dispenser, use a container and lift up each lever to flush away 10 litres of water (**Photo E**)
10. Turn on hot water switch (**Photo B**) and your AOX dispenser is now ready to serve your family

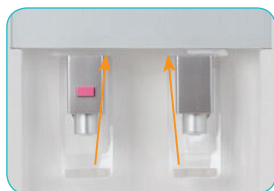

**Photo E**

Please lift up each lever to dispense AOX water



**Photo F**

Turn anti-clockwise (as shown above) to remove the cover. Tighten back the cover by turning clockwise after draining off water

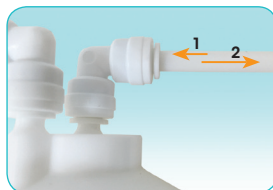

**Photo G**

Use your finger to push in the ring as shown in direction (1) and hold it while you pull out the tube as shown in direction (2)



**Photo H**

Insert the filters in the right sequence by following the colour code as shown above



**Photo I**

Turn on the water valve

### Notes:

It is normal to experience "popping" sound or to have lots of air bubble (that may cause the water to look cloudy) when the filters are new. This is due to the air trapped in the new filters.

If you find some particles in the water, please do not be alarmed. The particles are tested by independent labs to be activated carbon or alkaline minerals which is safe for consumption. The quality and taste of the water is dependent on the incoming water source and the filter's usage.

To ensure that you get optimal antioxidants and alkalinity, please follow the recommended filter change schedule. You may refer to the date written on the sticker (pasted on the side of the dispenser) or when you hear the FCT (Filter Change Timer) beeping.

## REPLACEMENT OF FILTERS

1. Please pay attention to the arrow mark of filters when you are changing your filters. (Diagram 1)
2. **Optimal Lifespan:**  
To ensure optimal antioxidant properties and alkalinity of the drinking water, it is recommended that you change your filters on every 6 to 9 month or 3,500 litres of usage (whichever comes first).  
  
The pH, antioxidant properties, taste and amount of water that produced by AOX filters may vary in accordance with the quality, pressure and temperature of the water source. If the incoming water has more suspended particles, it may "choke" the filter(s) before the recommended date.
3. **CAUTION:**  
**DO NOT USE** where the water is microbiologically unsafe or of unknown quality without adequate disinfection.  
  
**SHUT OFF THE WATER VALVE** – Whenever the water dispenser is left unattended overnight, on weekends or during holiday. This will prevent water pressure built up over time, which may cause accidental leakages.
4. **Maximum Pressure:**  
120 PSI

## HOW TO TURN OFF THE INLET WATER VALVE AND OPEN THE COVER?

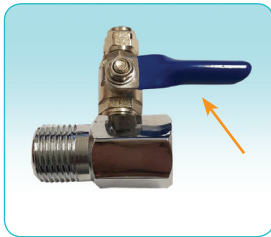

**Photo A**  
1. Turn off the water valve

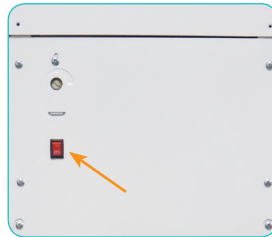

**Photo B**  
2. Turn off hot water switch. (Please take note that there is no cold water switch, the LED light for cold switch will be light up by default)

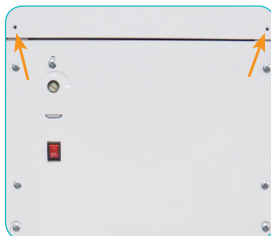

**Photo C**  
3. Unscrew the 2 nuts



**Photo D**  
4. Lift up the cover

## PARTS NAME

# Model No: AOX-6600H

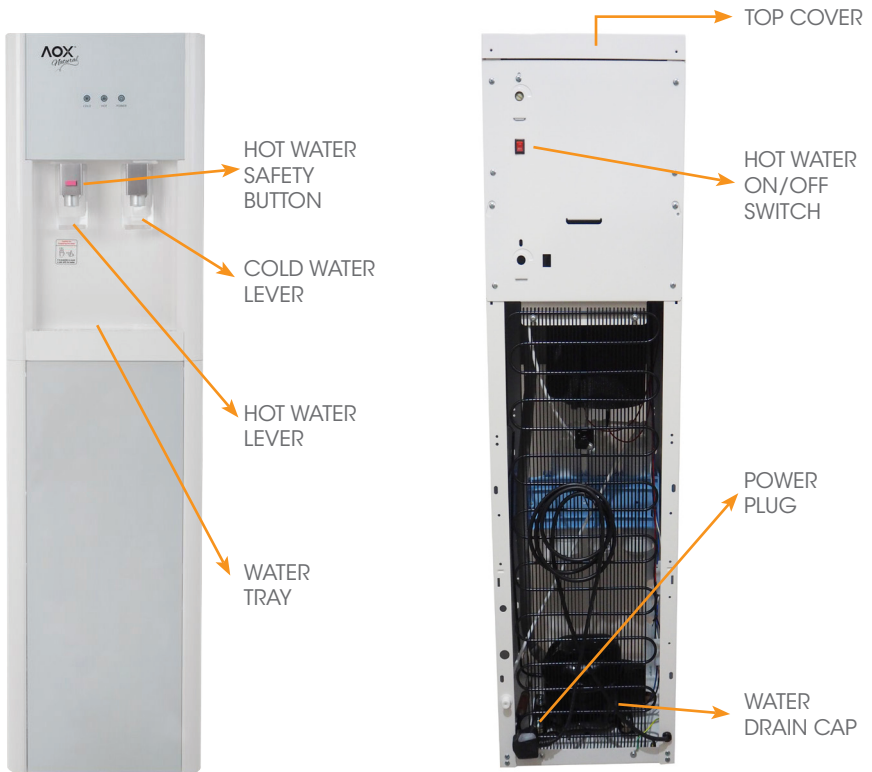

## SPECIFICATION

- HDST Technology – Heavy Duty Storage Tank
- AOX F3 Patent No: 10-0808904
- Tempered Glass Front Panel
- High Impact High Gloss ABS Resin
- Automatic Control for AOX Water Refill
- Safety Faucet for Hot Water
- All Stainless Steel Tank Capacity: 5L Hot Water (800W) / 6.2L Cold Water (110W)
- Chilling System: LG Compressor R-134a 40g Refrigeration Gas
- Water Temperature: Cold +/- 10 Degree Celsius, Hot +/- 80 degree Celsius
- Dimension (cm): W31 x D36 x H117 cm
- Net Weight: 21kg
- Gross Weight: 22.5kg
- Power Consumption: Compressor 0.7A , Heater 850W
- Power: AC220~240V / 50Hz

## TROUBLESHOOTING GUIDE

- Please check the following before asking for support.
- The dispenser may not operate properly because the user is not familiar with the product use even if it is not broken down.
- Please take the following measures. If there is still a problem, please contact Customer Service.

PROBLEM	CHECK	MEASURES TO TAKE
Indicator on the dispenser is not lighting up	Check if the main switch and Hot switch is switch on?	Try Off / On power
Hot or Cold water not dispensing out from dispenser.	Did you turn on the main water supply valve?  Did you change your filters regularly?	Turn on the main water supply valve.  Call up our Customer Service hotline.
Hot water not hot	Check if the Hot switch is switch on?  Check if you have given ample time for the Hot tank to heat up  Hot water requires 5minutes while Cold water is cold by default	Try resetting the heating sensor  Or  Call up our Customer Service hotline.
Water is leaking from the dispenser.	Check if the leakage could be from the connectors  It could be due to condensation. Try wiping off the water from the dispenser using a dry cloth and see if there is still leakage	Turn off the water supply valve from the tap water pipe and unplug the power cord. Call up our Customer Service hotline.



**Manufacturer:  
AOX PTE LTD**

**Made in KOREA**